

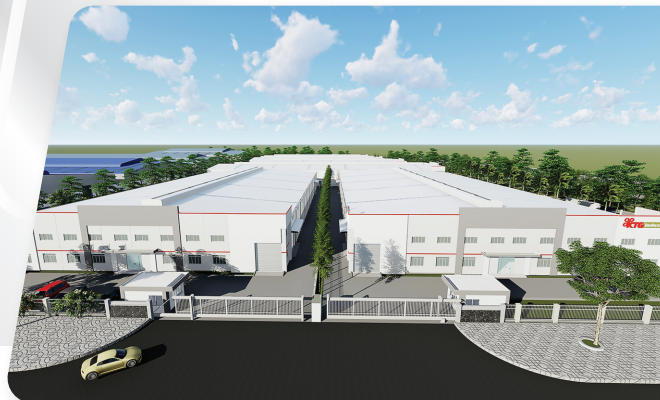









TAM PHUOC A Industrial Center

Tam Phuoc Industrial Park is situated in the Southern Economic Zone. The Park's completed technical and traffic infrastructure and its strategic location with close proximity to seaports, airports, hi-tech parks, and city centers helps manufacturers to save transportation time and costs.



AREA CONNECTIONS



-  **Ho Chi Minh City**
43km (75 minutes)
-  **High-Tech Industrial HCMC**
23km (40 minutes)
-  **Bien Hoa City**
17km (35 minutes)
-  **Thi Vai - Cai Mep Port**
48km (75 minutes)
-  **Cat Lai Port**
37km (60 minutes)
-  **Tan Son Nhat Airport**
38km (65 minutes)
-  **Long Thanh Airport**
26km (40 minutes)

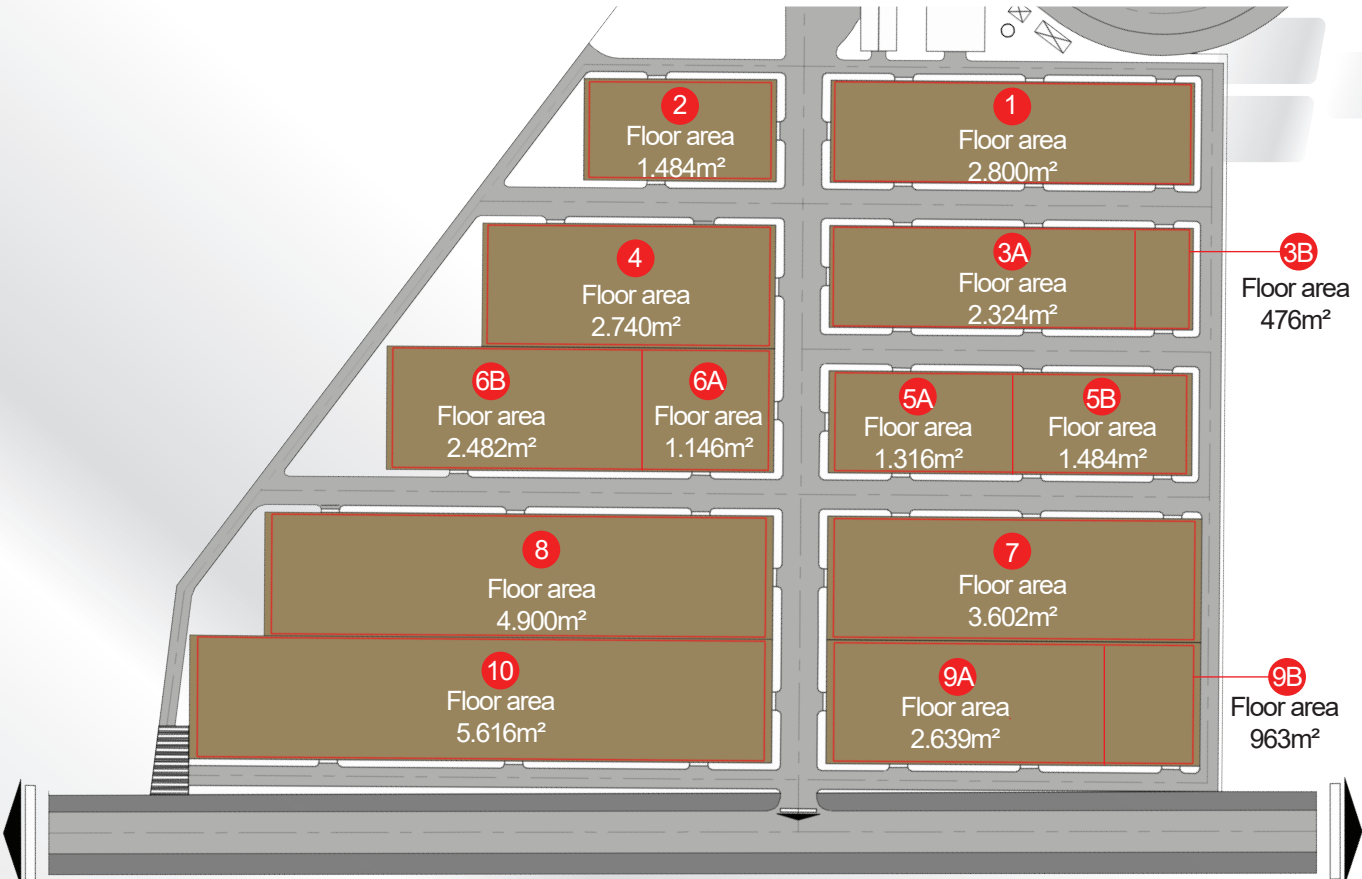

Location	Tam Phuoc Ward, Bien Hoa City, Dong Nai Province
Unit Size	1.484 - 5.616 sqm (including office)
Single-level Clear Height	8m
Floor Height	0.2 m
Floor loading	2 tons/sqm
Fire Safety	Fire hose reels. Stand-by branch-off for installation of sprinklers by tenants.
Flooring	Reinforced concrete flooring with surface hardening agent and polished layer.
Roofing	Corrugated iron roof with heat insulation.
Extra Benefits	Tax exemption and reduction according to industries and provision of law.



THE GENERATION OF TECHNOLOGY 4.0 FACTORY

Image 4.0 - Management 4.0 - Service 4.0 - Utilities 4.0



VR Factory



Extra Utilities



Customer Service App



All-in-One Service



Green Growth Strategy

Contact us for leasing:

(+84) 896 896 899

info@bkim.sg